

# **Φ25DC Tubular motor with built-in transformer**

## User Manual

Please read the user manual carefully before using the product

## Technical parameter

### Remote hunter101:

- Battery voltage: 3V
- Radio frequency: 433.92MHz
- Battery capacity: 210MAh
- Product size: 66\*33\*10MM

### MOTOR:

- Input voltage: AC110-220V(50/60Hz)
- Rated power: 12W
- One receiver can be compatible with 15 emitters at most

## Wire connection

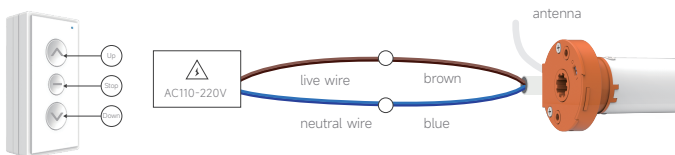

## Motor-remote operation

### Code pairing between motor and remote



Press the SET button on the motor head



Second, press the STOP button on the remote, the motor vibrates once. It means code pairing is successful

### Remote copy code



Press the UP and DOWN of remote at the same time until motor vibrates once



Press STOP 8 times



Press DOWN of A remote once the motor vibrates once which means the motor enters in code copy mode



Next, press the STOP button of new remote B the motor vibrates once Now remote B can also control the motor

Step by step or continuous running operation



Press the STOP and DOWN of remote at the same time  
the motor vibrates once  
the motor running mode will switch between step by step and continuous running in sequence.  
The factory default mode is continuous running mode

Release the control of current remote

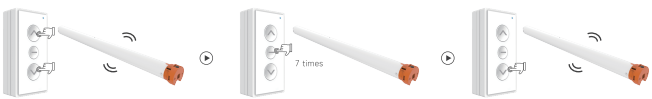

Press UP and DOWN at the same time  
the motor vibrates once

Press STOP 7 times

Then press DOWN  
the motor vibrates once  
release the current remote control successfully

Release the control of all remote controls

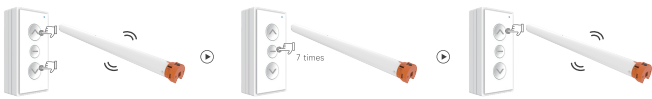

Press UP and DOWN at the same time  
the motor vibrates once

Press STOP 7 times

Then press UP  
the motor vibrates once  
release all remote controls successfully

Direction change

Method 1



Press motor SET button 5 times  
the motor vibrates once  
Changing direction is successful

Method 2



First, press UP and DOWN at the same time,  
the motor vibrates once

Press STOP once

Next, press UP again  
The motor vibrates once  
Changing direction is successful

## Set the limit position of opening



Let the motor stop at the designated position first  
press UP and DOWN at the same time  
until the motor vibrates once

Press STOP 5 times  
the step shall be finished in 10s  
or the device will exit the operation process

Next press UP once, the motor vibrates once  
the limit position of opening is set successfully

## Set the limit position of closing

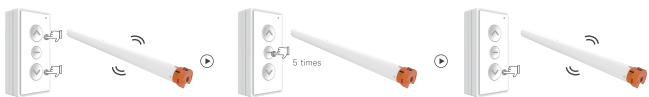

Let the motor stop at the designated position first  
press UP and DOWN at the same time  
until the motor vibrates once

Press STOP 5 times  
the step shall be finished in 10s  
or the device will exit the operation process

Next press DOWN once, the motor vibrates once  
the limit position of closing is set successfully

## Delete the limit position of opening

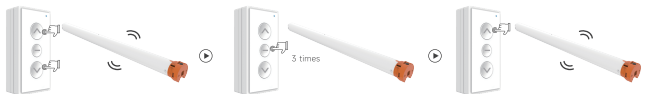

Press the UP and DOWN at the same time  
until the motor vibrates once

Press STOP 3 times

Press the UP once, motor vibrates once  
we delete the limit position of opening successfully

## Delete the limit position of closing



Press the UP and DOWN at the same time  
until the motor vibrates once

Press STOP 3 times

Press the DOWN once, motor vibrates once  
we delete the limit position of closing successfully



## Set the intermediate (third) position



Let the motor stop at the designated position first  
press the UP and DOWN at the same time

Press STOP once

Press DOWN once, the motor vibrates once  
the intermediate (third) position is set successfully  
(Only one intermediate position can be set)

## Reach to intermediate (third) position



The motor can run to the intermediate (third) position by long pressing  
the STOP button about 3S on the remote control

## Factory reset

### Method 1



Long press and hold the motor SET  
key until the motor finishes 3 vibrations  
After releasing the key, the motor  
will vibrate twice more. Factory reset is finished

### Method 2



Press the UP and DOWN at the  
same time until the motor vibrates once

Then long press the STOP until motor vibrates once  
after releasing the key, the motor will vibrate twice more  
Factory reset is finished

## DOS and DON'TS

1. This product is only for indoor use, do not use in humid environment or outdoor;
2. Pay attention to humid environments, do not sprinkle water or other liquids on the product;
3. Do not place the product near the heat source;
4. The motor wires cannot be replaced. If the wire is damaged, please do not use the device anymore, please contact your supplier to get a new one.

## Customer service

- 1.We promise that customer have 5 years guarantee due to the quality problem;
- 2.If due to improper installation, not according to the manual installation, caused by the fault or damage, the company will provide paid maintenance services;
- 3.Due to voltage resistance or abnormal voltage, abnormal temperature, water, fire, other force majeure caused by the fault or damage, the company provides paid maintenance services;
- 4.The company will not provide maintenance service for the failure or damage caused by artificial dismantling or unauthorized alteration of the product.

## Non-warranty clause

- 1.Unauthorized maintenance,misuse, collision, negligence, abuse, infusion, accident, modification, incorrect use of parts other than the product, or tear, alter label stickers, security marks;
- 2.The period of validity of warranty has exceeded;
- 3.Damage caused by force majeure;
- 4.Other than the product itself,technology,manufacturing,quality and other problems caused by damage or failure.

