

Φ35/45AC Electronic radio tubular motor

User Manual

Please read the user manual carefully before using the product

Technical parameter

Remote hunter101:

- Battery voltage: 3V
- Radio frequency: 433.92MHz
- Battery capacity: 210MAh
- Product size: 66*33*10MM

MOTOR:

- Input voltage: AC110-220V(50/60Hz)
- Loading power: <400W
- One receiver can be compatible with 15 emitters at most

Wire connection

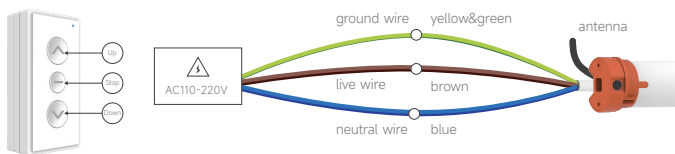

Motor-remote operation

Code pairing between motor and remote



Press the SET button on the motor head



Second, press the STOP button on the remote, the motor vibrates once, It means code pairing is successful



Remote copy code



Press the UP and DOWN of remote at the same time until motor vibrates once

8 times



Press STOP 8 times



Press DOWN of A remote once the motor vibrates once which means the motor enters in code copy mode



Next, press the STOP button of new remote B the motor vibrates once Now remote B can also control the motor

Step by step or continuous running operation



Press the STOP and DOWN of remote at the same time
the motor vibrates once
the motor running mode will switch between step by step and continuous running in sequence.
The factory default mode is continuous running mode

Release the control of current remote



Press UP and DOWN at the same time
the motor vibrates once



Press STOP 7 times



Then press DOWN
the motor vibrates once
release the current remote control successfully

Release the control of all remote controls



Press UP and DOWN at the same time
the motor vibrates once



Press STOP 7 times



Then press UP
the motor vibrates once
release all remote controls successfully

Direction change

Method 1



Press motor SET button 5 times
the motor vibrates once
Changing direction is successful

Method 2



First, press UP and DOWN at the same time,
the motor vibrates once



Press STOP once



Next, press UP again
The motor vibrates once
Changing direction is successful

Set the limit position of opening



Let the motor stop at the designated position first
press UP and DOWN at the same time
until the motor vibrates once



Press STOP 5 times
the step shall be finished in 10s
or the device will exit the operation process



Next press UP once, the motor vibrates once
the limit position of opening is set successfully

Set the limit position of closing

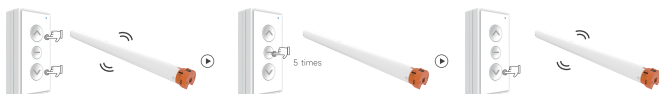

Let the motor stop at the designated position first
press UP and DOWN at the same time
until the motor vibrates once

Press STOP 5 times
the step shall be finished in 10s
or the device will exit the operation process

Next press DOWN once, the motor vibrates once
the limit position of closing is set successfully

Delete the limit position of opening



Press the UP and DOWN at the same time
until the motor vibrates once

Press STOP 3 times

Press the UP once, motor vibrates once
we delete the limit position of opening successfully

Delete the limit position of closing

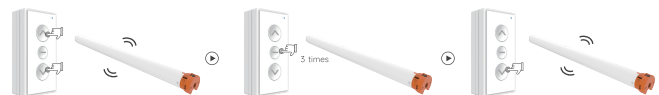

Press the UP and DOWN at the same time
until the motor vibrates once

Press STOP 3 times

Press the DOWN once, motor vibrates once
we delete the limit position of closing successfully

Set the intermediate (third) position



Let the motor stop at the designated position first
press the UP and DOWN at the same time

Press STOP once

Press DOWN once, the motor vibrates once
the intermediate (third) position is set successfully
(Only one intermediate position can be set)

Reach to intermediate (third) position



The motor can run to the intermediate (third) position by long pressing
the STOP button about 3S on the remote control

Factory reset

Method 1



Long press and hold the motor SET key until the motor finishes 3 vibrations
After releasing the key, the motor will vibrate twice more. Factory reset is finished

Method 2



Press the UP and DOWN at the same time until the motor vibrates once
Then long press the STOP until motor vibrates once after releasing the key, the motor will vibrate twice more
Factory reset is finished

DOS and DON'TS

1. Fixation and maintenance for the motor should be implemented by the authorized person;
2. After opening the package, check the motor to make sure whether it appears deformation, damage and the accessory is completely attached;
3. The electrical outlet must include the grounding wire connection terminal and it should be connected with the ground fully;
4. The motor should be done a test on the condition of no load and insure that it does not appear abnormal noise.

Customer service

1. We promise that customer have 5 years guarantee due to the quality problem;
2. If due to improper installation, not according to the manual installation, caused by the fault or damage, the company will provide paid maintenance services;
3. Due to voltage resistance or abnormal voltage, abnormal temperature, water, fire, other force majeure caused by the fault or damage, the company provides paid maintenance services;
4. The company will not provide maintenance service for the failure or damage caused by artificial dismantling or unauthorized alteration of the product.

Non-warranty clause

1. Unauthorized maintenance, misuse, collision, negligence, abuse, infusion, accident, modification, incorrect use of parts other than the product, or tear, alter label stickers, security marks;
2. The period of validity of warranty has exceeded;
3. Damage caused by force majeure;
4. Other than the product itself, technology, manufacturing, quality and other problems caused by damage or failure.

